

# Overall Dimensions and Performance Parameters of DCL-100/160/250

Type Performance Parameters	DCL-100			DCL-160			DCL-250		
	AC110V	AC220V	AC380V	AC110V	AC220V	AC380V	AC110V	AC220V	AC380V
Motor Power	120W	120W	90W	140W	140W	100W	140W	140W	100W
Rated Current	1.93A	0.94A	0.44A	1.75A	0.96A	0.46A	1.75A	0.98A	0.48A
Standard Time/Torque	30S/1000Nm			48S/1600Nm			75S/2500Nm		
Optional Time/Torque	15S/500Nm								
Turning Angle	0~90° Adjustable								
Available Control Circuit	Types of A、B、C、D、E、F、H								
Total Weight	19kg			19.5kg			20kg		
Insulating Resistance	AC110V/AC220V/AC380V: 100 MΩ/500VDC								
Withstand Voltage Class	AC110V/AC220V:1500VAC 1minute、AC380V:1800VAC 1minute								
Protection Class	IP67								
Installation Angle	360° at any angle								
Electric Interface	Two G1/2 Water-proof Cable Connectors, one for power line and one for signal line.								
Ambient Temperature	-30°C ~ +60°C								
Optional Function	◆Over-torque Protector ◆Dehumidify Heater ◆Dome indicator ◆Handle								



Standard type



Direct installation type

## Standard type

## Direct installation type (DCL-100, 160)

## Direct installation type (DCL-250)

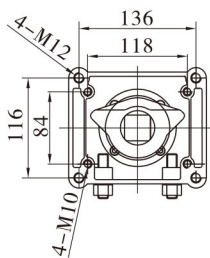
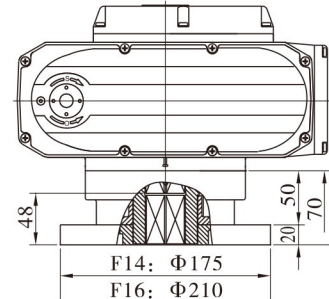
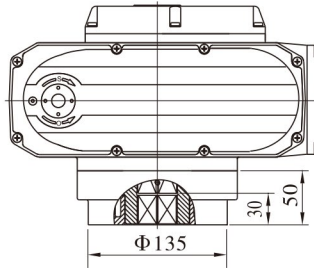
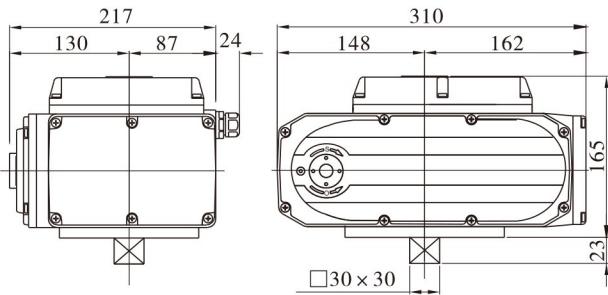

Parameters of Direct installation		
	DCL-100\160	DCL-250
Square	□ 22×22 □ 27×27	□ 27×27 □ 36×36
Flange	F10 F12	F14 or F16
Valve stem	Height ≤ 30mm	Height ≤ 48mm

